

MONTIGO[®]
the art of **fireplaces**

H34, H34VO,
H38 ONLY

HBK
DIVINE LINER INSTALLATION**

- The installation of this KIT must be done by a qualified and certified gas appliance installer.
- Check local codes and read all instructions prior to installation.

NOTICE

Installer: Leave this manual with the appliance.
Consumer: Retain this manual for future reference.

⚠ WARNING

Some materials used in the manufacturing process of this product can expose you to Benzene which is known in the State of California to cause cancer and birth defects or other reproductive harm. For more information go to www.P65warnings.ca.gov

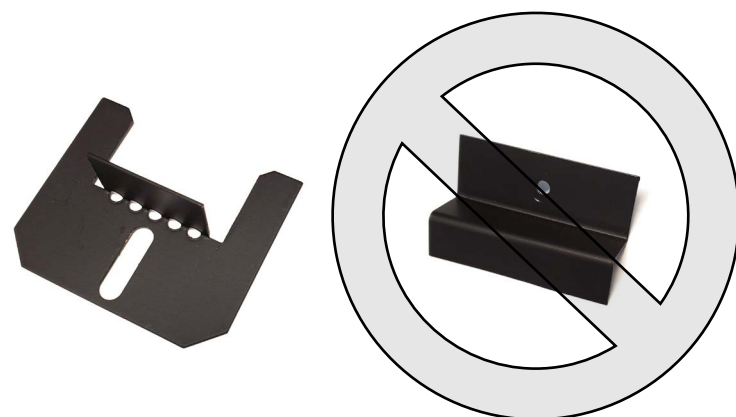

IMPORTANT

The brick liner kit includes 2 different sets of clips. for H34, H34VO, and H38 use the clips shown above

Installation

If necessary, remove the baffle at the top of the firebox to ease the install of the liners. Baffle must be reinstalled once liners are in place.



- 1** Place the rear panel in the rear track of the media tray. Orient the panel so the open slot will be at the top

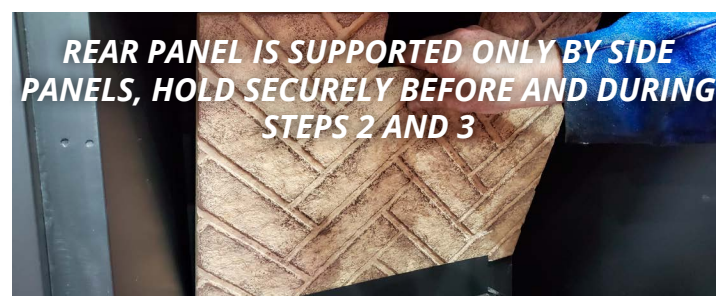

THIS SECTION ONLY FOR H34VO INSTALLS

- 1** Place the rear panel on the RIM of the media tray. Orient the panel so the open slot will be on the bottom (this will be covered by the logset later on)

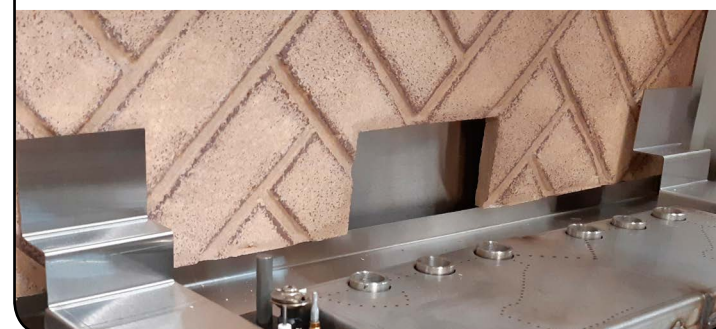

- 2** Slide the side pieces behind the rim of the media tray. secure with the included clip at the top of the firebox.

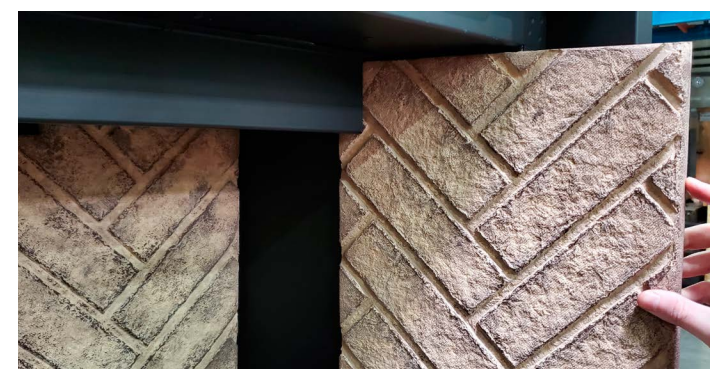

- 3** Repeat for other side.

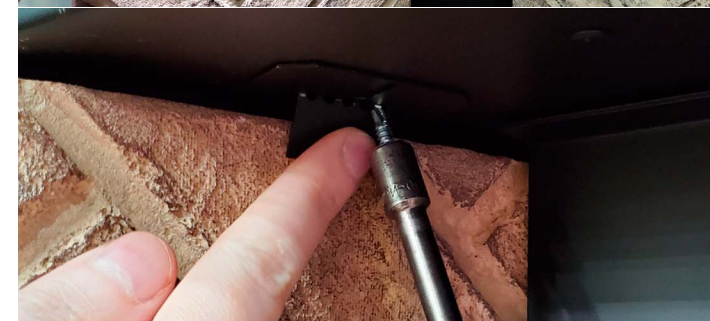
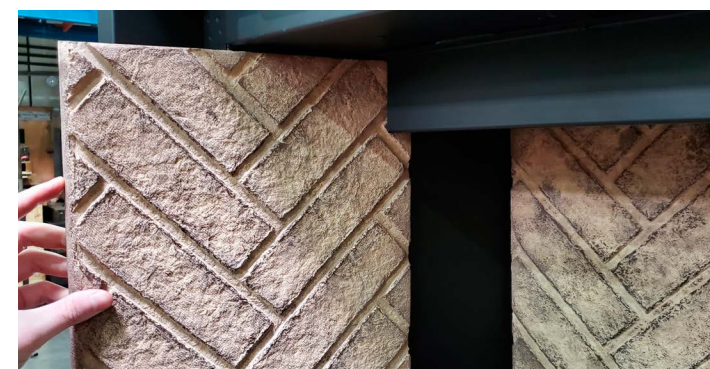

- 4** Install logset, lavarock, and embers. Re-install doors and safety screen.



MONTIGO[®]
the art of **fireplaces**

H42, H42VO,
H38VO, ONLY

HBK**
DIVINE LINER INSTALLATION

- The installation of this KIT must be done by a qualified and certified gas appliance installer.
- Check local codes and read all instructions prior to installation.

NOTICE

Installer: Leave this manual with the appliance.
Consumer: Retain this manual for future reference.

WARNING

Some materials used in the manufacturing process of this product can expose you to Benzene which is known in the State of California to cause cancer and birth defects or other reproductive harm. For more information go to www.P65warnings.ca.gov

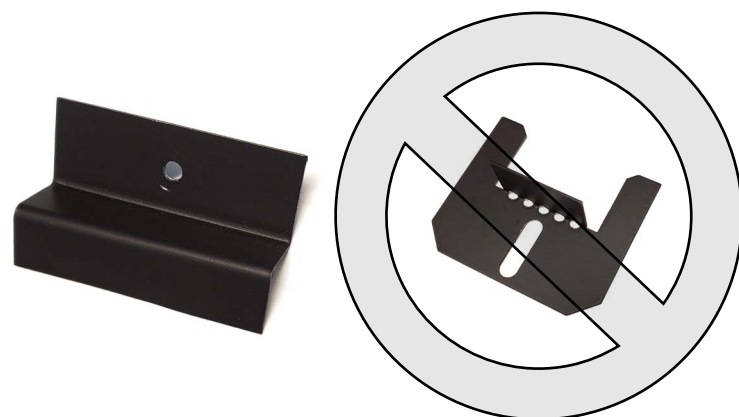

IMPORTANT

The brick liner kit includes 2 different sets of clips. for H42, H42VO, and H38VO use the clips shown above

Installation

- 1** Place the rear panel on the RIM of the media tray. Orient the panel so the open slot will be on the bottom (this will be covered by the logset later on)



THIS SECTION ONLY FOR H42 INSTALLS

- 1** Place the rear panel in the rear panel slot of the media tray. Orient the panel so the open slot will be on the top of the firebox.



If necessary, remove the baffle at the top of the firebox to ease the install of the liners. Baffle must be reinstalled once liners are in place.



- 2** Slide the side pieces behind the rim of the media tray. secure with the included clip at the top of the firebox.

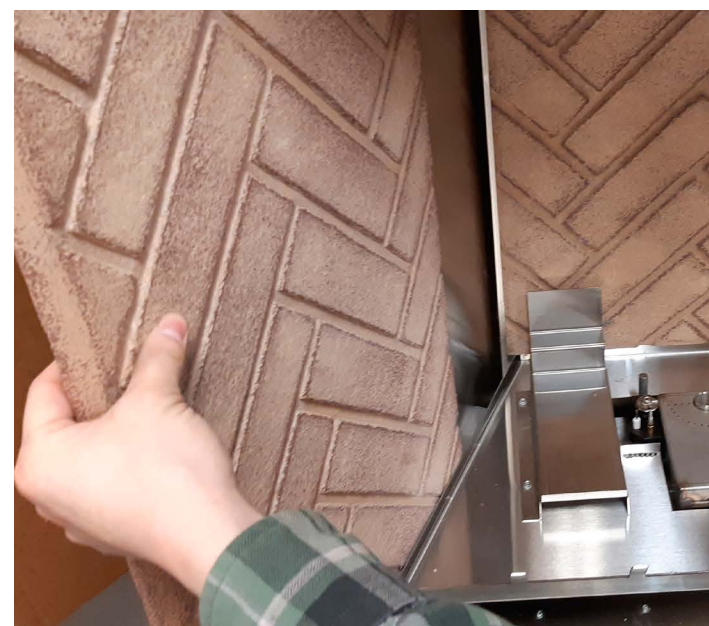

- 3** Repeat for other side.



- 4** Install logset, lavarock, and embers. Re-install doors and safety screen.

